

Dimming

FX 48V Track luminaires can be dimmed. Unios recommends a 1-10V dimmer or DALI system optimised for LED technology. For non-standard configurations refer to driver data sheet.

For full list of compatible drivers, see unios.com

For instructions on setting up Casambi, please visit unios.com/casambi.

Load Bearing Guide

Note: This is a guide only and is intended to provide general information. Final load bearings are dependent on screws and mounting anchors used. It is the responsibility of the electrical contractor to check final weights.

Surface mounted

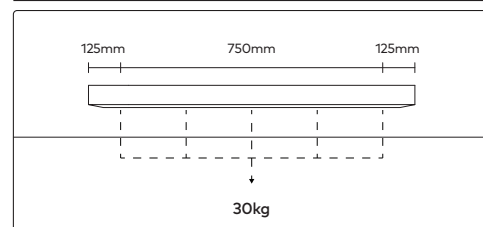

Suspended

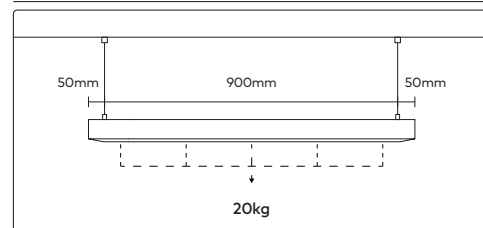

Trimless Recessed

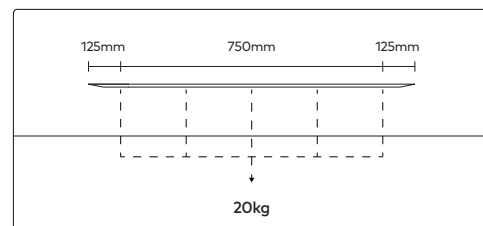

Track Cutting

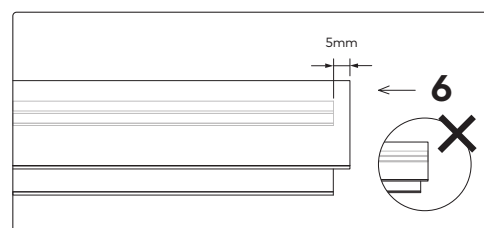
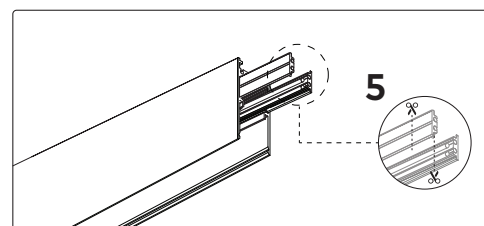
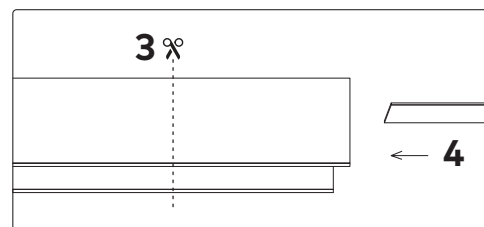
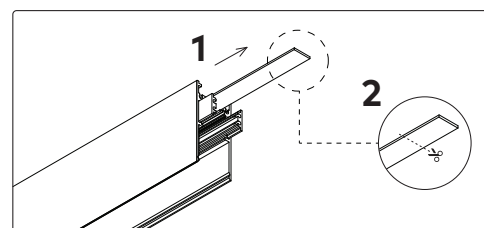

Ambient Conditions

Recommended to install the FX Trimless Track in an ambient temperature <35°C.



FX

48V TRACK SERIES

Base Codes (Surface Mounted)	3 metre track FXST3000	2 metre track FXST2000	1 metre track FXST1000
Base Codes (Trimless Recessed)	3 metre track FXTT3000	2 metre track FXTT2000	1 metre track FXTT1000
48V DC 15A max	IP Rating 20	Material Aluminium	Install Person/s 1-2x

CAUTION – This product must be installed by a qualified installer
Please read instruction manual carefully before installing luminaire

Surge Protection
For comprehensive protection of a luminaire against electrical surges, surge protection shall be installed on the mains supply where required to protect luminaires and drivers from transient voltage damage.

For warranty information visit unios.com/warranty

Please read these installation instructions carefully before installing this product. This product must be installed and maintained by a suitably qualified person/s in compliance with the latest applicable regulations and relevant legislation.

Unios does not warrant any claim based on defects or damage caused by misuse, improper installation, improper operation and/or modifications carried out by the purchaser or third parties. This product shall not be used as a 'working light' during construction. This will result in the warranty of the product to be void. For warranty duration, please refer to the data sheet.

Safety Instructions

- The FX 48V track has a maximum capacity of 15A or 720W. Consider LED driver output limitations when designing track systems and ensure only FX 48V luminaires are energised on this track system.
- Do not force the adaptor into a position or connection. It is the responsibility of the installer to ensure electrical, mechanical and thermal compatibility between the FX 48V track system and the luminaires installed on it.
- Ensure FX 48V Track is installed a minimum of 150mm from any combustible surface or material.
- Under no circumstances should the FX 48V track be installed in wet or damp conditions.
- For DALI configurations, it is a requirement to use a DALI isolator to provide SELV (Safety Extra-Low Voltage) isolation in accordance with applicable Australian Standards. The installing contractor is responsible for ensuring all wiring complies with the relevant codes and standards.
- FX 48V track is comprised of aluminium extrusion, copper tracks and thin steel flat bar. When cutting FX 48V track, ensure a clean cut is achieved by using a suitable cutting device.
- Do not use free hand saws for cutting track. Remove any burrs to remove short circuit situations and ensure track is clean and free of any loose debris.
- Do not supply power to track at more than one connection point.

FX 48V Surface Mounted Track

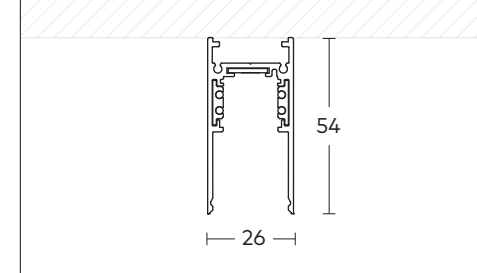

FX 48V Trimless Recessed Track

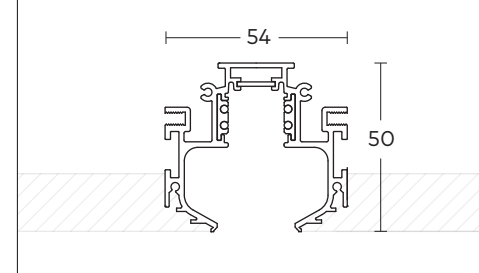

Surface Mounted Mounting Guide

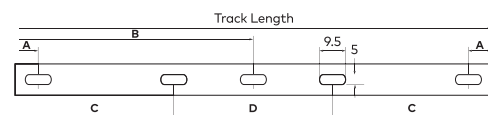
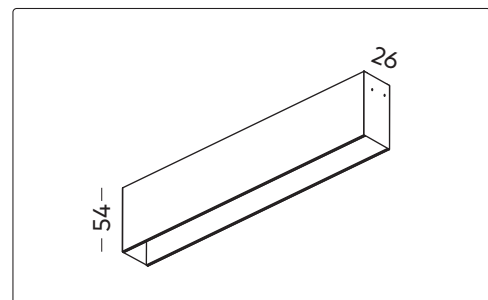

Length	A	B	C	D
1000	125	-	-	-
2000	125	998	-	-
3000	125	-	914	1167

All measurements are in millimetres.

Trimless Recessed Mounting Guide

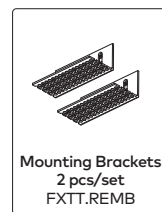
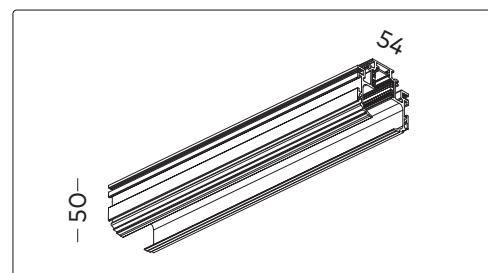

Length	Set Qty
1000mm	2
2000mm	3
3000mm	4

Mounting brackets are required to mount recessed product.

⚠ IMPORTANT – Polarity

DIM+ terminal on trackheads needs to be connected to the same copper pole as the DIM+ terminal on the Live End for dimming on 1-10V configurations. DALI configurations are not polarity sensitive.

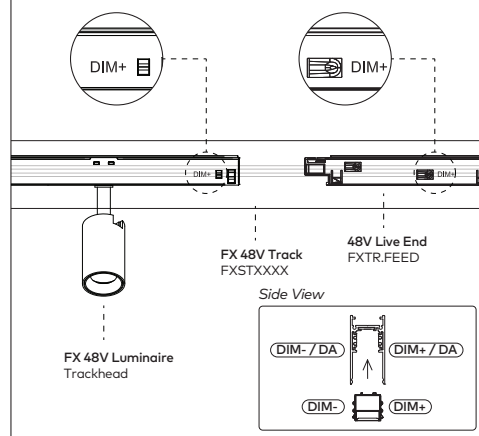

48V Live End

FXTR.FEED

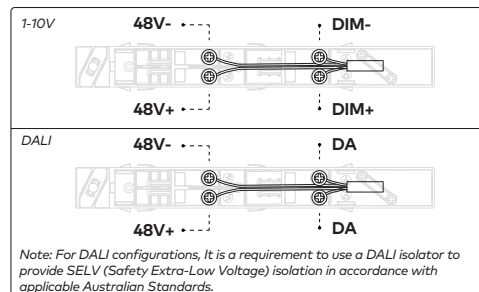
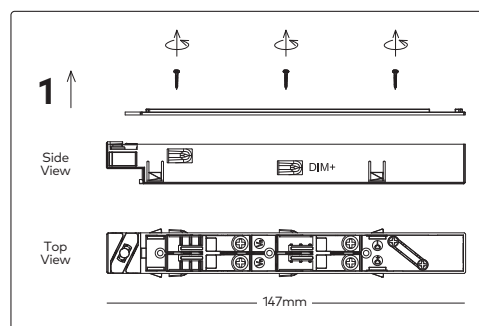

Trimless Recessed L-Connection

FXTR.ADJL supplied separately
2x FXTT.SCTC included

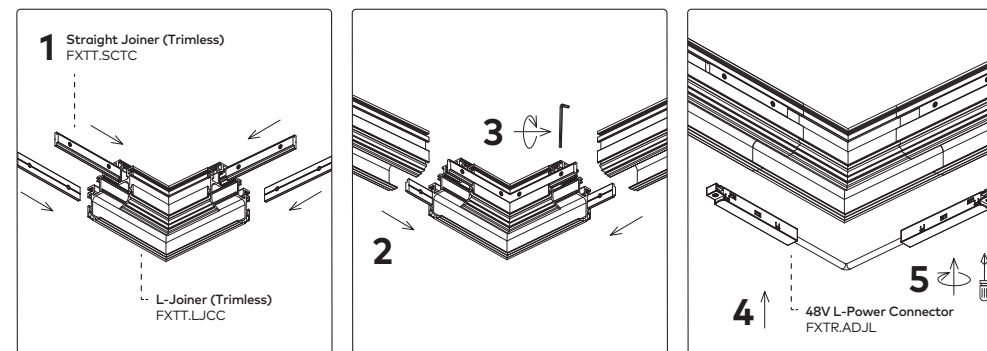

Trimless Recessed T-Connection

FXTR.ADJT supplied separately
3x FXTT.SCTC included

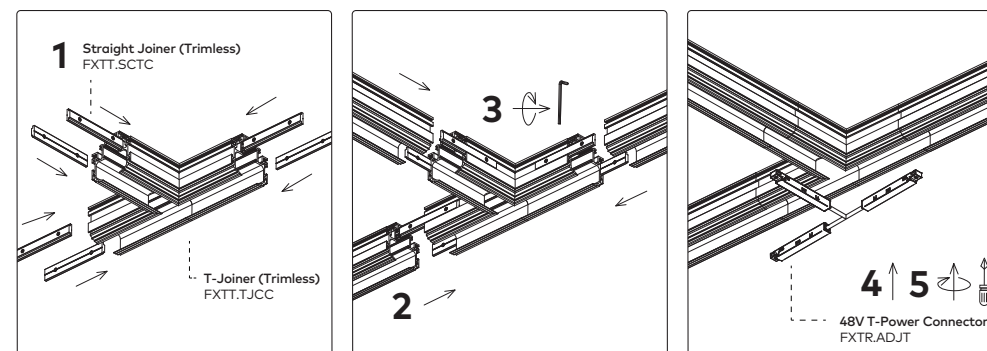

Trimless Recessed Cross Connection

FXTR.ADJC supplied separately
4x FXTT.SCTC included

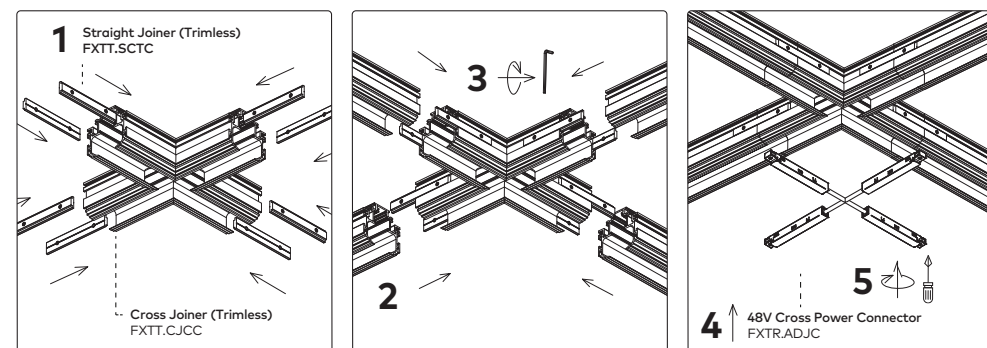

Trimless Recessed

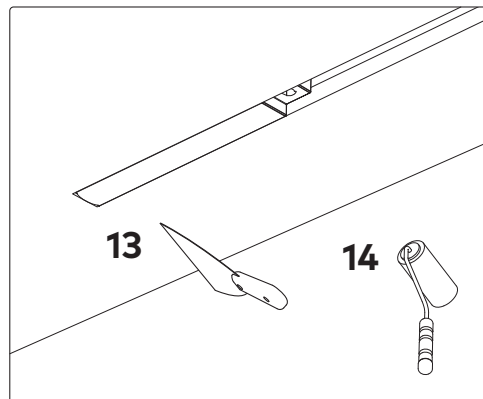
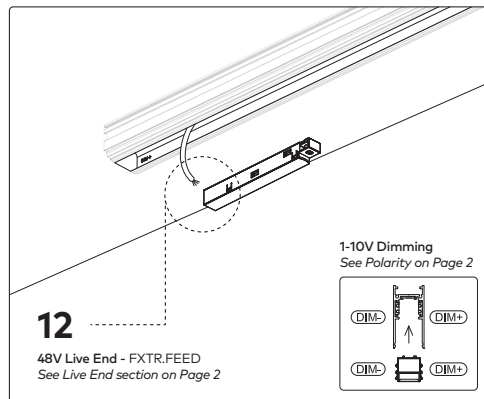
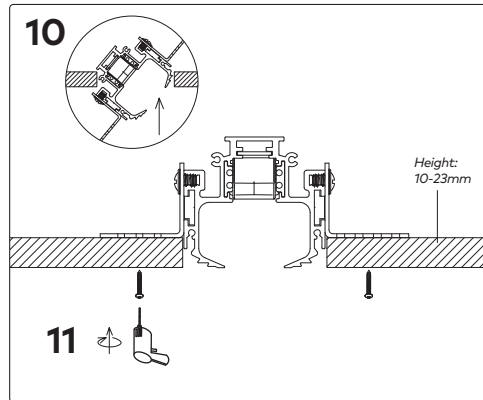
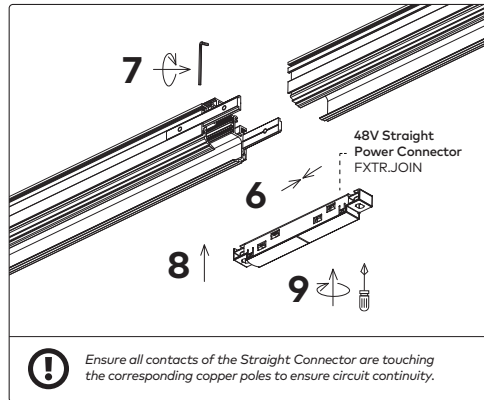
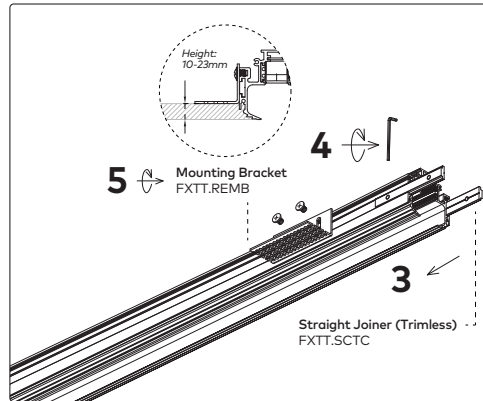
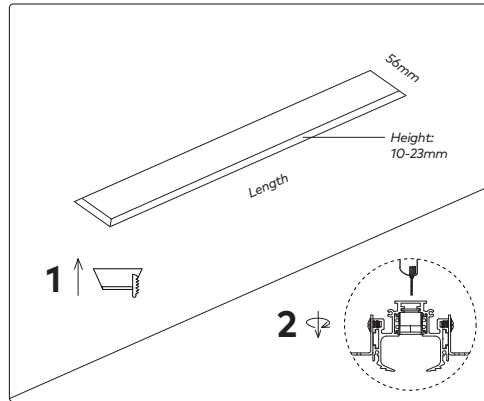

Wiring

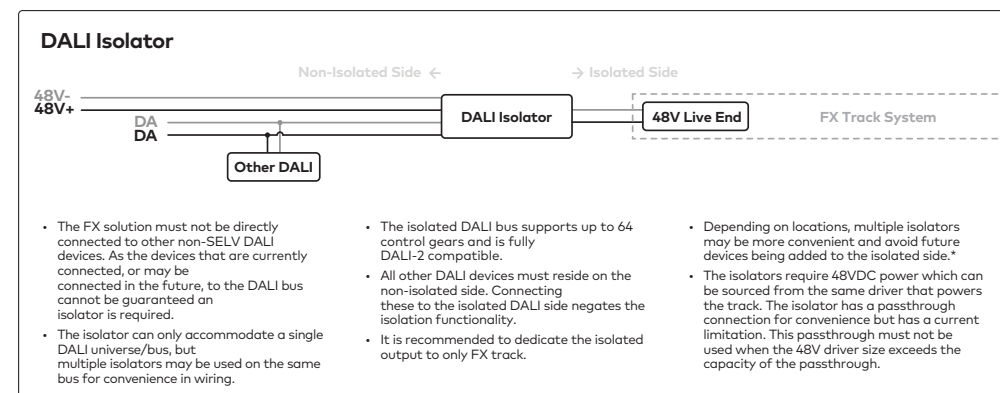
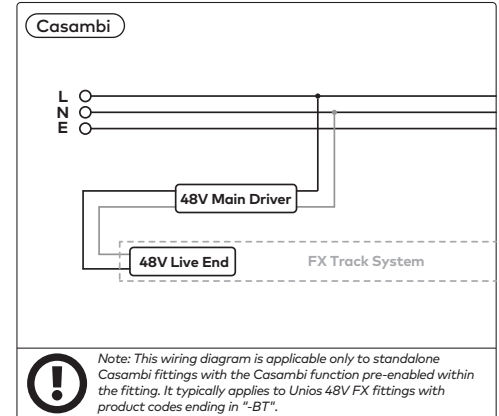
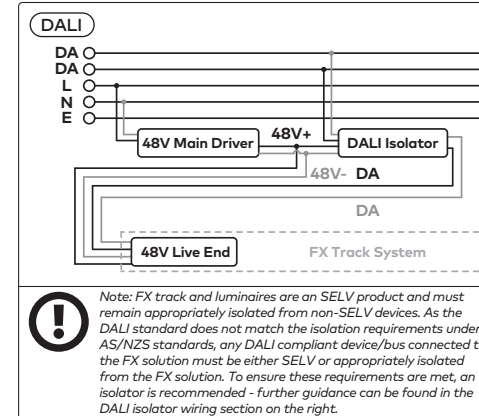
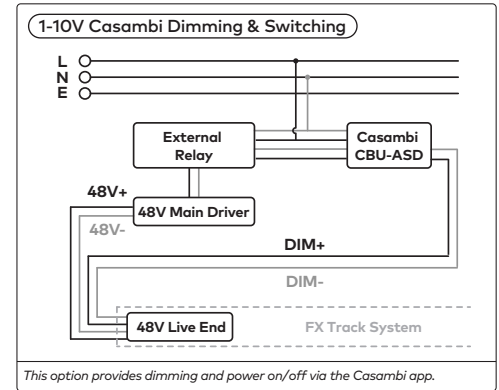
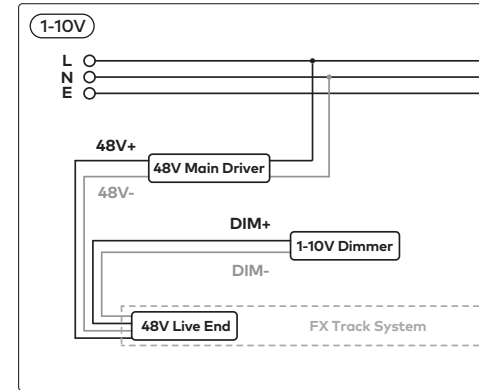

Surface Mounted

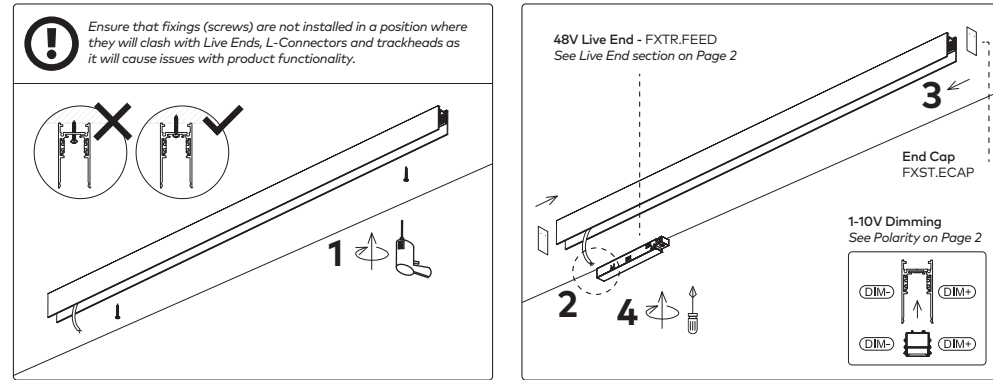

Suspended

Suspension Kit is supplied as an additional accessory

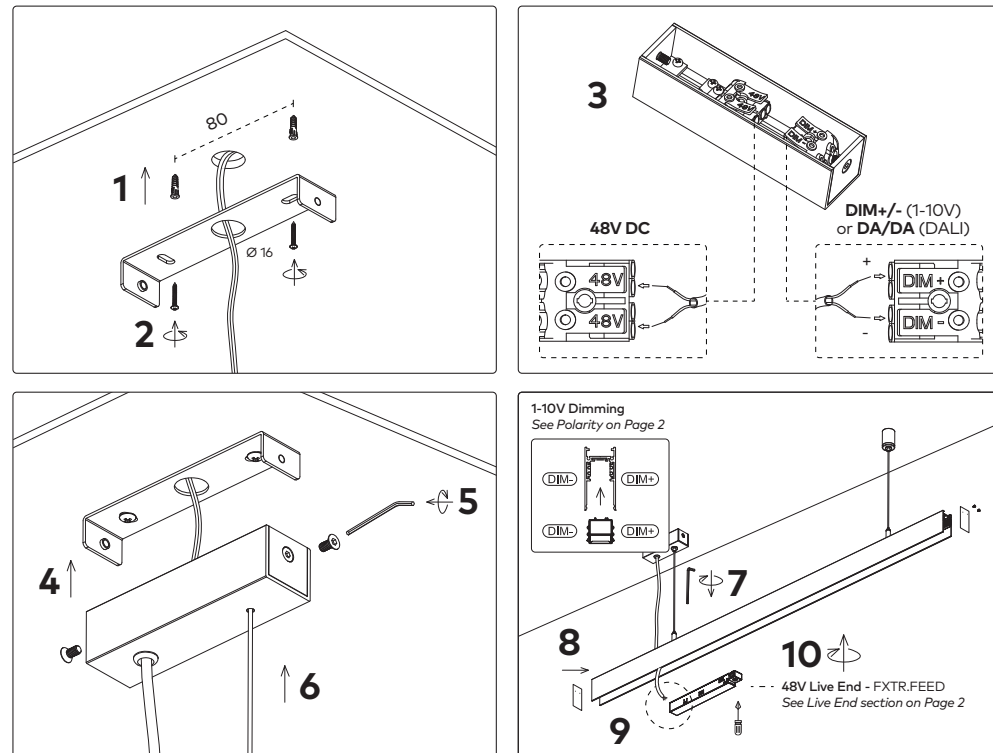

L-Connection

FXTR.ADJL supplied separately

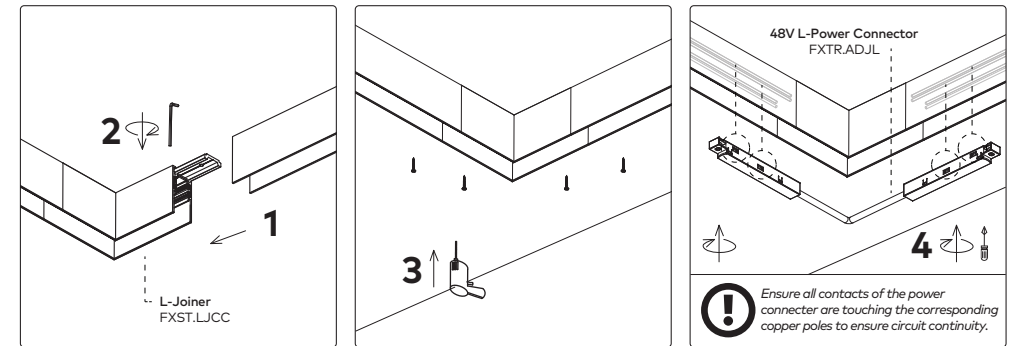

T-Connection

FXTR.ADJT supplied separately

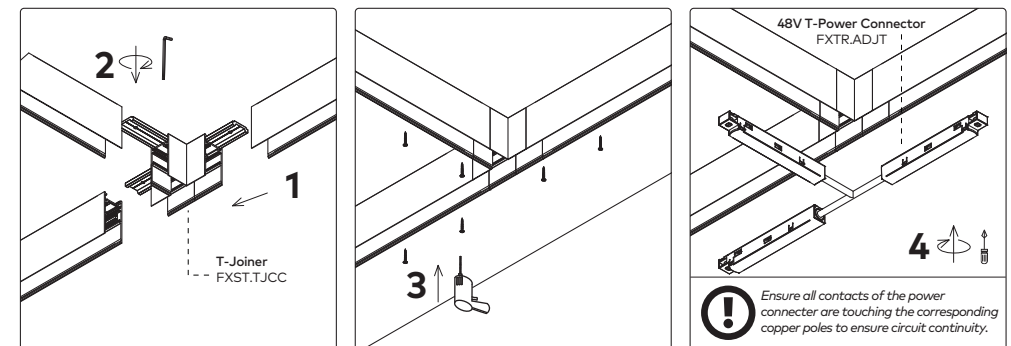

Cross Connection

FXTR.ADJC supplied separately

